



FTCO 1319 EC Flat Tachograph

Product Family EC Tachographs

By its reduced mounting depth and the automatic feed, positioning and ejection of the tachograph chart, the flat tachograph 1319 sets new standards in the field of performance, technology and design. The TCO 1319 is a tamperproof source of information for both driver and vehicle fleet, whether used as an individual component or within the Integrated Driver Information System KIIFIS. Thanks to the optimal evaluation of driver- and vehicle-related data, it allows efficient tour scheduling while reducing the operating costs. Accidents can be reconstructed to the second, quite often for the driver's defence.

Features

- Low mounting depth of only 80 mm thanks to its low-profile design
- Automatic recording of driving times for the driver and of passive working time for the co-driver
- Multifunctional LC display for the indication of total distance, daily distance as well as of preset warning levels
- Front illumination in night design
- Automatic chart ejection after 24 hours
- Automatic cutoff of working time motor after 25 hours (reduced power consumption)
- Electronically analysable recordings

EC Flat Tachograph 1319

Scope of functions

Display

- Analog: road speed, time, clock, check, a.m./ p.m.
- Multifunctional LC display: daily / total km driven, warning signals

Recording

- Road speed
- Distance
- Working times (time groups)
- Opening marks
- Recording period 24 h
- 2 drivers
- Engine speed and additional stylus - optional

Time groups

- Driving times
- Other periods of attendance at work
- Other working times
- Breaks and rest periods

Technical Information

Measuring range	100, 125, 180 km / h	(3300 min-1)
Operating temperature	-25°C ...+70°C	
Operating voltage	12 or 24 V	
Power consumption (standby)	typ. 35 mA at 12 / 24 V	
Pulse range	2,400 - 99,999 imp / km	(engine 2,05 - 200 imp / rev)
Inputs	v-sensor, test socket, programming interface	
Outputs	v-pulse, diagnostic plug, FMS	
Tolerances	± 3 km / h ± 200 U / min ± 5 s/d distance ± 1% km	
Protection	IP54 acc. To EN 60529	
EMC	DIN / VDE 0879T3 / IEC801 - 2 / ISO7637 / DIN 40839	
Vibrations	10 - 60 Hz, 0,35 mm	60 - 2000 Hz, 5g
Casing	Noryl (PPO) with 20% glass fibre	
Scope Weight	approx. 1400 g	(engine speed version approx. 1430g)
Available special equipment	Additional stylus, connection for current limiter for the carriage of dangerous goods, distances-independent signal 4 imp / m, stop and go signal, connection for external speed warning contact. All materials used in the tachograph can be recycled.	

Fitting dimensions (in mm):

150 x 210 x 81

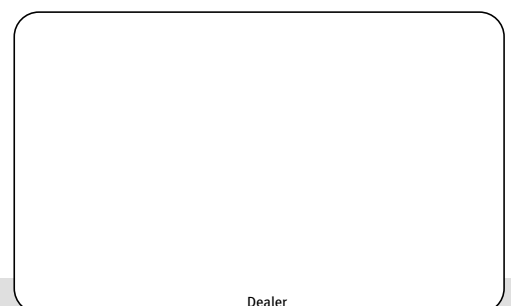
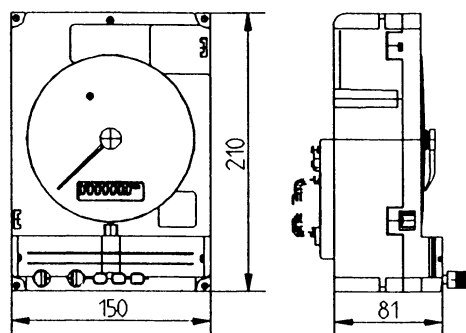

Dealer